



society  
house

DOWNTOWN • DUBAI

A CITY WITHIN  
THE CITY.



INVEST  
GROUP  
OVERSEAS  
مجموعة الاستثمار

COME HOME TO  
SOCIETY HOUSE AND  
BELONG SOMEWHERE  
EXCEPTIONAL.

This isn't your average address. Society House is for those select few who appreciate being a little closer to the action.

Those whose ambitions no few bounds. Those who feel drawn to the undeniable magic and energy of downtown life.

Those like you. The like-minded. The move-makers, the operators, the visionaries who see the world as an eternal opportunity, dressed in different time zones.

This is your home. These are your people.



## DEVELOPMENT OVERVIEW.

A BOLD VISION FOR BOLD INDIVIDUALS.

The vision with Society House Downtown was to create a purpose-finished HQ from which playmakers and jet-setters could enjoy their world. The building would be a reflection of their never-ending drive and would exist as a symbol in the world's most dynamic city.

It would be a place where they could come to feel like they truly belonged, surrounded by like-minded individuals who valued the same pursuit. And so Society House Downtown opened its doors.

## AN ICONIC ADDRESS IN AN ICONIC CITY.

DOWNTOWN DUBAI - WHERE CUISINE, NIGHTLIFE AND COUTURE INTERSECT.

If you're looking for a place to see and be seen, Downtown Dubai is it. This electrifying neighbourhood is home to some of the city's most iconic landmarks - not least of which is the world's tallest building, the Burj Khalifa. From thrill-rides to cult-status brands and dining, Downtown Dubai quite literally has it all. A short stop from the city's main business district, it's the place ideal for those who want it all.

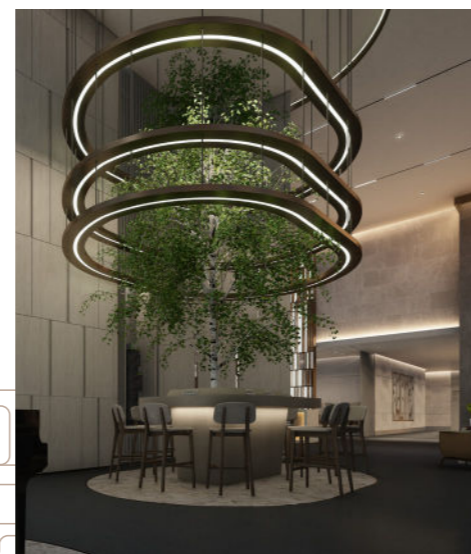

## EVERYTHING YOU COULD EVER IMAGINE - AND MORE.

FOR RESIDENTS WHO LIVE FOR IT ALL.

From a celebrity-like fitness routine to calming downtime and from vibrant entertainment to the odd business meetings, the thoughtful amenities at Society House will equip you for a world-class lifestyle.

- Outdoor CrossFit 'box'
- Fitness studio
- Golf simulator
- Residents lounge
- Private cinema
- Serviced office space and meeting rooms
- Outdoor horizon deck and bar area
- 25m lap pool
- Padel courts
- Kids play area



## BE FLOORED, OVER 52 TOWERING STOREYS.

CLAIM YOUR PLACE AT SOCIETY HOUSE TODAY.

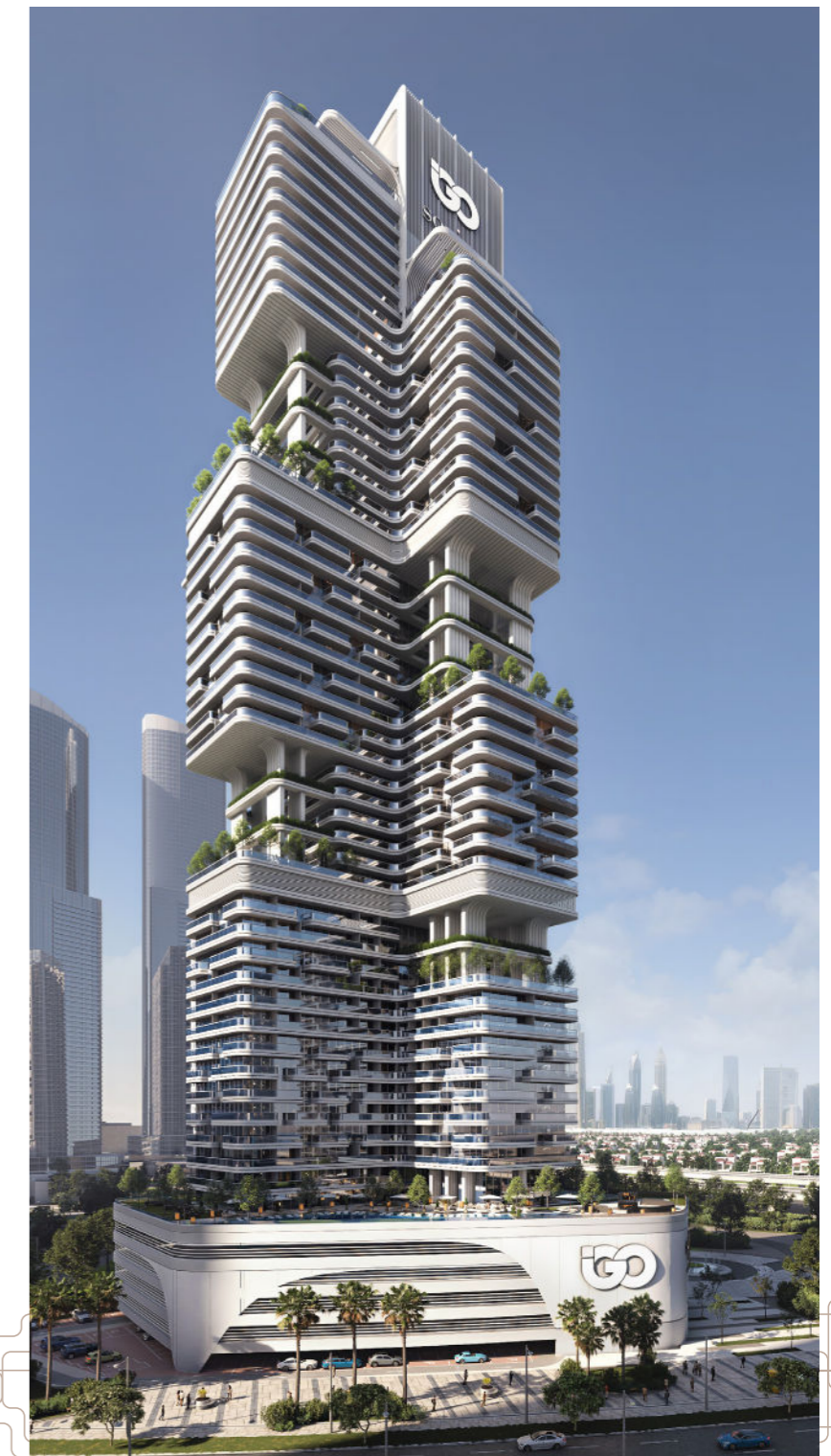

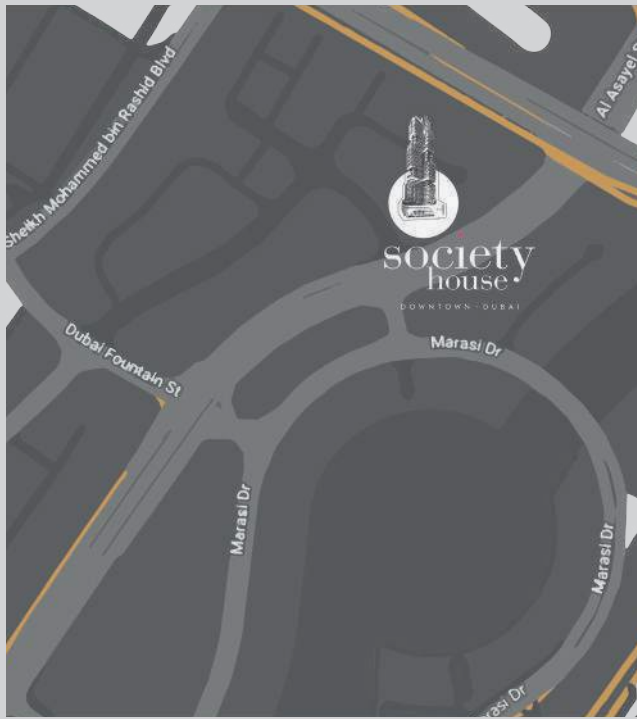

## ISN'T IT TIME YOU GATHERED WITH THE LIKE-MINDED?

### AREAS:

#### STARTING FROM

**Studio starting from:**  
354 sq.ft / 32.89 sq.m

**1 Bedroom starting from:**  
688.62 sq.ft / 63.98 sq.m

**2 Bedroom starting from:**  
1158 sq.ft / 107.60 sq.m

**3 Bedroom starting from:**  
2839 sq.ft / 263.71 sq.m



CALL 800DEVMARK

### PAYMENT PLAN:

#### OPTION 1: NON POST - HANDOVER PAYMENT PLAN

INSTALLMENT.	TERMS	%PAID
1.	Immediate / On Signing a Sales and Purchase agreement	20%
2.	After 5 Months from launching date	10%
3.	After 10 Months from launching date	10%
4.	After 15 Months from launching date	10%
5.	After 20 Months from launching date	10%
6.	Upon Handover	40%

#### OPTION 2: POST - HANDOVER PAYMENT PLAN

PAYMENT NO.	DATE	%PAID
1.	Immediate / On Signing a Sales and Purchase agreement	20%
2.	After 5 Months from launching date	10%
3.	After 10 Months from launching date	10%
4.	After 15 Months from launching date	10%
5.	After 20 Months from launching date	10%
6.	Upon Handover	10%
7.	After 3 Months from handover	5%
8.	After 6 Months from handover	5%
9.	After 9 Months from handover	5%
10.	After 12 Months from handover	5%
11.	After 15 Months from handover	5%
12.	After 18 Months from handover	5%

Disclaimer: Any images and visualizations contained herein are provided for illustrative and marketing purposes only. All information contained herein is subject to change without notice and without liability and only the information contained in the final Sales and Purchase Agreement entered into between the Seller and Buyer will have any legal effect. E&OE